



- Water Bottle Refill Station
- Standard Water Fountain

DWG. NO.:	REVISION DATE:
A-1	08-03-2018
BLDG. CODE:	SCALE:
HS	NTS
	DESIGN BY:
	PLL
	CHECKED BY:
	JCD

**RECORD FLOOR PLAN
HENSON SCIENCE BUILDING**

FIRST FLOOR PLAN

SALISBURY UNIVERSITY
 FACILITIES PLANNING & CAPITAL PROJECTS
 ARCHITECTURAL AND ENGINEERING SERVICES
 1101 CAMDEN AVENUE
 SALISBURY, MARYLAND 21801
 410 - 543 - 6215

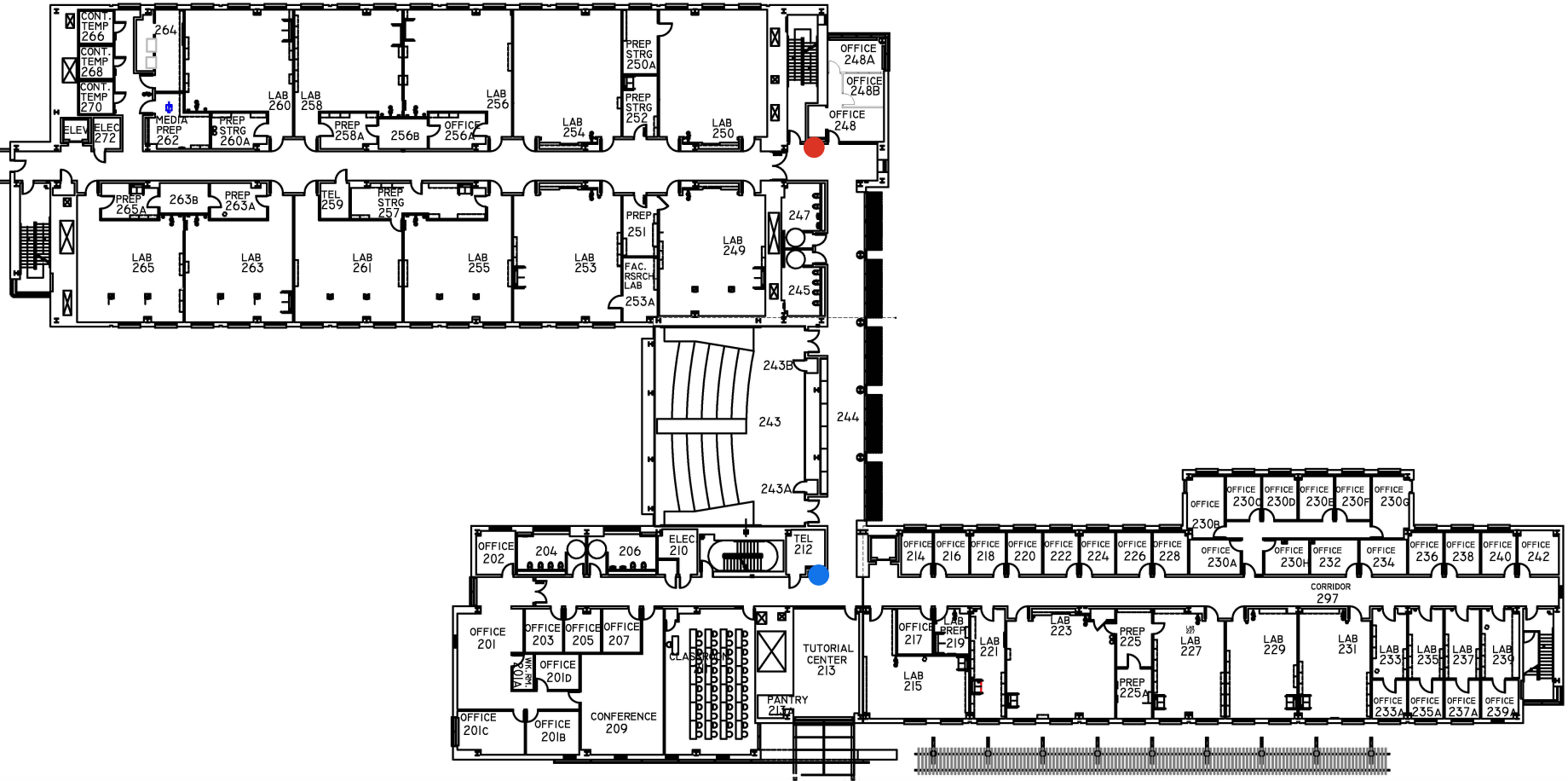
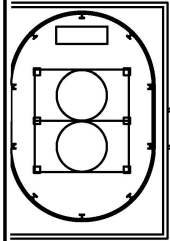

- Water Bottle Refill Station
- Standard Water Fountain

DWG. NO.:	REVISION DATE:
A-2	09-13-2019
BLDG. CODE:	SCALE:
HS	NTS
	DESIGN BY:
	PLL
	CHECKED BY:
	JCD

**RECORD FLOOR PLAN
HENSON SCIENCE BUILDING**

SECOND FLOOR PLAN

SALISBURY UNIVERSITY
 FACILITIES PLANNING & CAPITAL PROJECTS
 ARCHITECTURAL AND ENGINEERING SERVICES
 1101 CAMDEN AVENUE
 SALISBURY, MARYLAND 21801
 410 - 543 - 6215

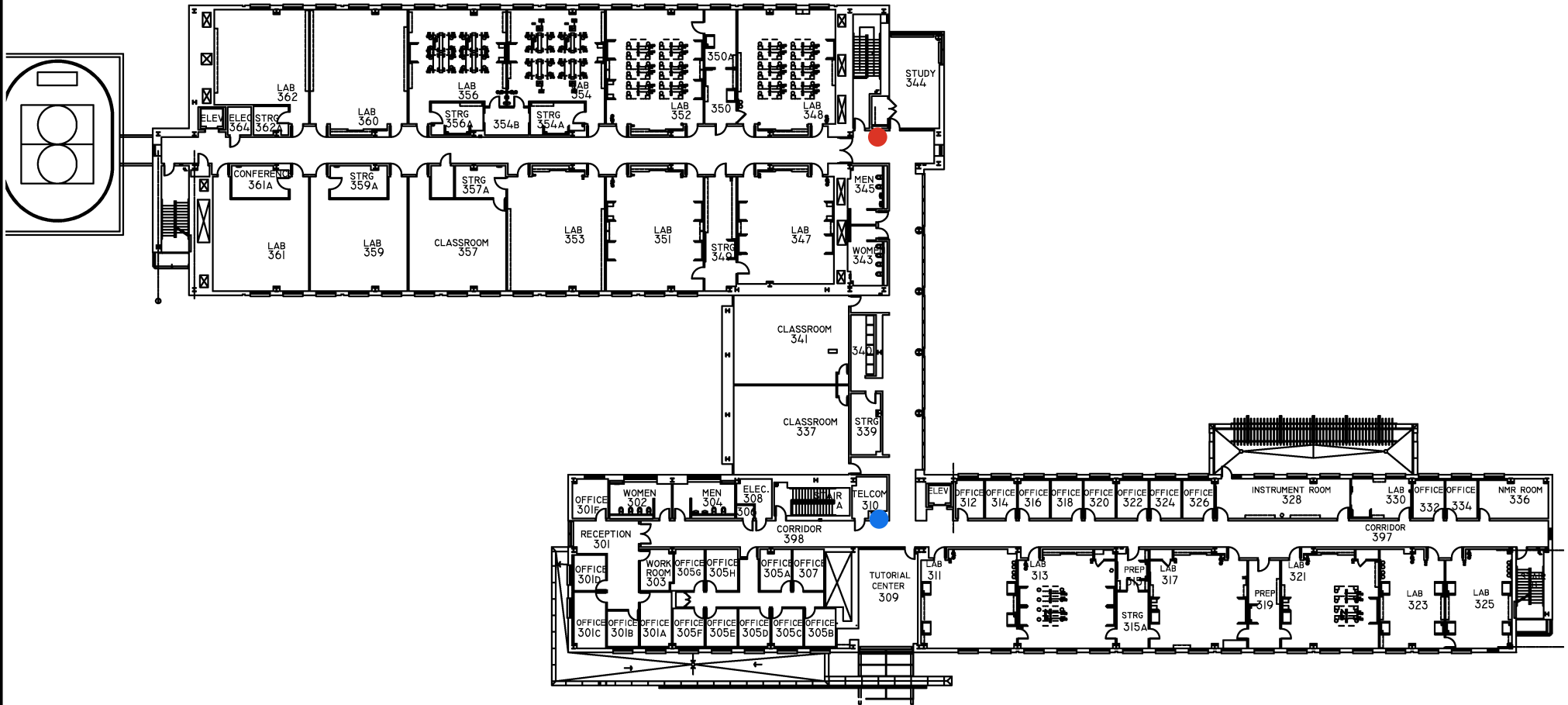

● Water Bottle Refill Station

● Standard Water Fountain

DWG. NO.:	REVISION DATE:
A-3	08-13-2018
BLDG. CODE:	SCALE:
HS	NTS
	DESIGN BY:
	PLA
	CHECKED BY:
	JCD

RECORD FLOOR PLAN
HENSON SCIENCE BUILDING

THIRD FLOOR PLAN

SALISBURY UNIVERSITY
 FACILITIES PLANNING & CAPITAL PROJECTS
 ARCHITECTURAL AND ENGINEERING SERVICES
 1101 CAMDEN AVENUE
 SALISBURY, MARYLAND 21801
 410 - 543 - 6215